

BAWAH RESERVE

# GUEST FACT SHEET



Bawah  
RESERVE





## THE RESORT AT A GLANCE

- 6 islands
- 3 marine reserve lagoons
- 13 private beaches
- 100 hectares of primary forest
- 2 restaurants
- 2 bars / casual dining
- Infinity swimming pool
- Wallace Library
- Activities lawn
- Resort boutique (Six Islands Trading Post)
- Aura Spa & Wellbeing
- Air-conditioned gym & Jungle gym
- Hiking trails
- Countless water activities
- Architecture walks
- Permaculture gardens & tours
- Classes & workshops
- Island-wide WiFi
- Foundation & conservation education
- Endless bespoke experiences

Bawah Reserve is a sustainable resort offering a spectacular private island experience in Indonesia's remote Anambas archipelago. Our earth-first philosophy guides everything we do; it's why we established a come-as-you-are, relaxed environment built upon the tenets of authenticity, excellent service and respect for our islands' natural wonders.

Daily rates include spa treatments, island activities (both on land and sea) and the exquisite cuisine made from ingredients grown in Bawah's own gardens. With six islands, three lagoons, 13 beaches and 100 hectares of untouched forest, guests have their own natural playground to explore.



## JOURNEY

# 160 MILES NORTHEAST OF SINGAPORE IN INDONESIAN WATERS



**The journey to the resort can start either in Singapore or Batam, Indonesia.**

### SINGAPORE

Guests are picked up from the airport, a hotel or a private residence – by Bawah’s preferred, outsourced car service and driven to Tanah Merah Ferry Terminal. From there, Bawah’s travel host escorts guests on a 30-minute ferry ride to the Indonesian island of Batam. On arrival, guests are driven to Batam airport where they board Bawah’s amphibious seaplane for an 80-minute flight, landing on the water in the resort’s main lagoon.

### BATAM

Guests are picked up via private car service from their hotel or residence in Batam. Guests may opt to fly directly into the Hang Nadim Airport (BTH) where they will be met upon arrival for direct transfer to Bawah’s amphibious seaplane.

### PRIVATE JET

Guests wishing to travel to Bawah Reserve via private jet should plan to fly directly into the Hang Nadim Airport (BTH) for direct transfer to Bawah’s amphibious seaplane.

### PRIVATE YACHT

We welcome guests to Bawah Reserve who are travelling via private yacht. Reservations are required for mooring and there are size limitations within our lagoons.

## GOOD TO KNOW

- Journey from Singapore 4 hours (approx)
- Journey from Batam 3 hours (approx)
- Amphibious seaplane flight 80-minute
- Up to 2 seaplane flights per day, 6 days per week
- Baggage allowance: strictly 15 kg, inc. hand luggage, due to seaplane weight restrictions. Excess luggage may be stored with our ground staff
- An overnight stay in [Singapore](#) or [Batam](#) is recommended before your trip due to our early morning pick up times





## SLEEP

# 36 EARTH CONSCIOUS STAND-ALONE SUITES ARE ENVELOPED BY NATURE



Air conditioning and overhead fan



Digital Tablet



In-room safe



Unlimited Bawah Reserve still & sparkling water



Unlimited Wi-Fi



Organic bathroom amenities



Room service



Complimentary Tea & Coffee making facilities



Bathrobe & Slippers



Minibar



Hairdryer



Bawah Reserve snacks

### (1) Garden Suites 70m<sup>2</sup>

Located behind the beach suites, across the main pathway and surrounded in lush green forest.

### (15) Beach Suites 70m<sup>2</sup>

Bamboo tented beach suites lining the southern coast of the Reserve with direct beach access.

### (11) Overwater Bungalows 105m<sup>2</sup>

Built over the shallow turquoise lagoon waters; well appointed for a spectacular panorama of the archipelago.

### (1) Two-bed Treehouse Lodge 140m<sup>2</sup>

Offering one king and one twin bedroom, ensuite bathrooms, attic den, dining and lounge area and sea views from an expansive veranda surrounded by trees.

### (1) Two-bed Garden Pool Villa 203m<sup>2</sup>

Located behind the beach suites, surrounded in lush green forest. The garden pool villa has two standalone king canopy bed suites with ensuite bathrooms. Suites are connected by a semi-covered dining and lounge pavilion and a private plunge pool.

### (2) Two-bed Deluxe Pool Villas 200m<sup>2</sup>

Beachfront pool villa with two adjoining suites with ensuite bathrooms (one king, one twin), separate covered dining and lounge pavilion, pool and direct access to the beach.

### (1) Three-bed Deluxe Pool Villas 310m<sup>2</sup>

Option to add interconnected suite via a covered walkway. The third ensuite bedroom is a standalone beach suite, separate but connected to the main villa.

### (2) Two-bed Infinity Pool Villas 203m<sup>2</sup>

Beachfront pool villa with two separate, standalone suites with ensuite bathrooms (two kings), connected covered dining and lounge pavilion, infinity pool and direct access to the beach.

### (1) Four-bed Infinity Pool Villa 750m<sup>2</sup>

Option to add interconnected villa via a covered walkway. Offering four king or twin bedroom suites with ensuite bathrooms, two central dining and lounge pavilions and two plunge pools with sea views. Perfect for families or groups travelling together but also looking for individual privacy.





## RATES & PACKAGE

### SUITE INCLUSIONS

- Air-conditioned canopied bedroom with a ceiling fan
- Bath, rain shower, twin sinks
- Minibar with coffee, tea, still and sparkling mineral water and Bawah snacks
- Private covered veranda
- Safe, bathrobes, slippers
- Beach bag, beach towels, sun hats
- Snorkel equipment
- Mobile phone linked to resort staff
- Natural toiletries and insect repellent
- Hairdryer
- Twice-daily room cleaning and turndown service

### PACKAGE INCLUSIONS

- Daily breakfast, lunch, dinner
- Non-alcoholic beverages
- Yoga, Pilates and meditation classes
- One spa treatment pp/per night
- Water and land activities
- Laundry service
- Resort-wide WiFi
- Room tax and service charges

### EXCLUSIONS

- Alcoholic beverages
- Diving
- Bespoke experiences
- \$950 USD transport package per person for 2022

### RATES IN USD \$ STARTING FROM /PER NIGHT

Garden Suite	\$1780
Garden Pool Villa	\$1780
Beach Suite	\$2080
Overwater Bungalow	\$2520
Treehouse Lodge	\$3480
2-bed Deluxe Pool Villa	\$4980
3-bed Deluxe Pool Villa	\$6650
2-bed Infinity Pool Villa	\$4580
4-bed Infinity Pool Villa	\$9160



- \* Peak season rates apply
- \* Occupancy based on two adults per room
- \* Extra bed per suite, per night: Adult \$600, child (5-12 yrs) \$450
- \* Minimum 3 night stay



SLEEP

# ACCOMMODATION FLOORPLANS

GARDEN SUITE



BEACH SUITE



GARDEN VILLA





## OVERWATER BUNGALOW



## TREEHOUSE LODGE





**TWO-BED DELUXE POOL VILLA**



**TWO-BED INFINITY POOL VILLA**



**INTERCONNECTED THREE-BED DELUXE AND/OR FOUR-BED POOL VILLA**







## TASTE

# UNIQUE DINING EXPERIENCES FROM THE SEA TO THE TREES

**The Reserve offers two restaurants, two bars and endless private dining experiences across its six islands**

### TREE TOPS

Refined continental and Indonesian cuisine served amongst the rainforest canopy.

### THE BOAT HOUSE

Delectable local seafood with a sand-between-your-toes experience and ocean views from every table.

### THE GROUPER

The heart of the island and all-day meeting spot for coffee, light bites and cocktails overlooking the ocean and the infinity pool.

### JULES VERNE

A hideaway at the resort summit for garden-to-glass bespoke cocktails and post-dinner drinks.



**THE  
GROUPER**

**THE  
BOAT HOUSE**

**JULES  
VERNE**



# COUNTLESS UNIQUE EXPERIENCES IN NATURAL SURROUNDINGS



**Whether you want to explore the islands by foot or by boat, get pampered at Aura Spa or dive into adventurous marine activities, Bawah Reserve offers it all.**

## PLAY

### ABOVE

- » Infinity swimming pool
- » Boat trips
- » Twice daily Aura Wellbeing movement classes
- » Guided and unguided forest hiking
- » Stargazing with zero light pollution
- » The Wallace Library
- » Starlight beach cinema nights
- » Weekly beach BBQs
- » Permaculture gardens and tours
- » Island architecture walks
- » Indonesian cooking classes
- » Art classes
- » Indonesian Batik making

### BELOW

- » Guided and unguided lagoon snorkelling
- » Kayaking and guided kayak excursions
- » Stand-up paddleboarding
- » Catamaran Sailing
- » Scuba diving and Padi courses

### BEYOND

- » Aura Spa Explorer experiences on a private island
- » Castaway picnics on private beaches
- » Private dining across the Reserve
- » Accredited Marine Conservation Area and education
- » Anambas Foundation day trips to neighbouring islands
- » Stand-up paddleboard breakfast







## BALANCE

### AURA SPA

Offering traditional spa therapies designed to relax, invigorate and rejuvenate. All-natural ingredients and handmade scrubs complement every spa ritual.

### AURA WELLBEING

Daily movement classes are designed to bring true balance to your body, mind and soul. Scheduled group classes and one daily spa treatment are included in the rates.

### AURA SPA EXPLORER

Journey beyond the spa walls with our Spa Explorer experience at one of our idyllic outdoor bale locations.

## BROWSE

### THE WALLACE LIBRARY

A quiet sanctuary with books and games to be enjoyed in a tranquil setting. Situated above Tree Tops restaurant, guests can enjoy sunset views of the main lagoon.

## SHOP

### SIX ISLANDS TRADING POST

Bawah Reserve's island boutique offers resort clothing, local giftware and holiday essentials. In line with Bawah's values, most brands are locally and sustainably sourced.



DOWNLOAD [ACTIVITIES PLAY BOOK](#)

# OUTDOOR ACTIVITIES



## ACTIVITY KEY

### DIVE SITES



### SNORKEL TRAILS



### HIKING TRAILS



### SUP & KAYAK TRAILS



### REEF CONSERVATION



## ISLANDS (PULAU)

- |           |               |
|-----------|---------------|
| 1 Bawah   | 4 Elang       |
| 2 Muerba  | 5 Lidi        |
| 3 Sanggah | 6 Batu Tokong |

## BEACHES (PANTAI)

- |                 |                  |
|-----------------|------------------|
| 1 Barat         | 10 Turtle Point  |
| 2 Coconut Kecil | 11 Sanggah Kecil |
| 3 Coconut       | 12 Elang Kecil*  |
| 4 Sunrise       | 13 Elang Timur*  |
| 5 Boat House    |                  |
| 6 Timur         |                  |
| 7 Muerba        |                  |
| 8 Sanggah       |                  |
| 9 Turtle        |                  |

\* Reserved for the private use of Elang guests

## POINTS OF REFERENCE

- |                          |                   |
|--------------------------|-------------------|
| A Jules Verne Bar        | J Utara Lookout   |
| B Main Lookout           | K East Lagoon     |
| C Trail Access           | L Seaplane Lagoon |
| D Solar Farm             | M Boat Lagoon     |
| E West Lookout           |                   |
| F Sunset View Lookout    |                   |
| G Coconut Lagoon Lookout |                   |
| H Coconut Lagoon         |                   |
| I Coconut Beach Lookout  |                   |





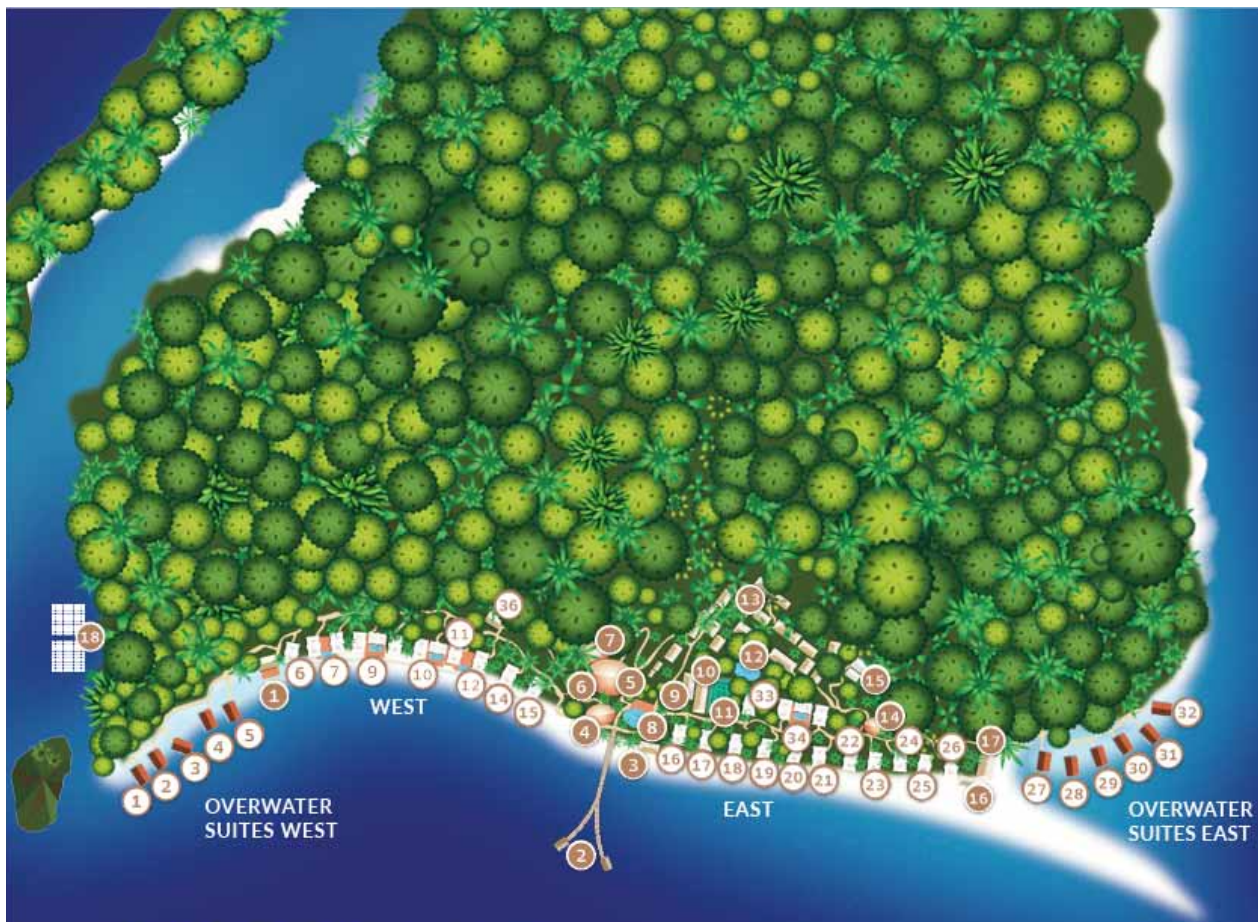

# RESORT MAP

## GUEST SUITES

- 1 – 5 Overwater Suites West
- 6 Beach Suite West
- 7 2-Bed Infinity Pool Villa
- 9 2-Bed Deluxe Pool Villa
- 10 Tented Beach Suite West
- 9 & 10 3-Bed Deluxe Pool Villas
- 11 2-Bed Deluxe Pool Villa
- 11 & 12 4-Bed Pool Villas
- 12 2-Bed Infinity Pool Villa
- 14 – 15 Tented Beach Suites West
- 16 – 26 Tented Beach Suites East
- 27 – 32 Overwater Suites East
- 33 Tented Garden Suite
- 34 2-Bed Garden Pool Villa
- 36 2-Bed Treehouse Lodge

## ISLAND FACILITIES

- 1 Aura Wellbeing
- 2 Jetty
- 3 Guest Relations
- 4 Grouper Bar
- 5 Tree Tops Restaurant
- 6 The Wallace Library
- 7 Jules Verne Bar
- 8 Infinity Pool
- 9 Six Islands Trading Post
- 10 Pavilion Belajar
- 11 Activities Lawn
- 12 Permaculture Gardens
- 13 Staff Village
- 14 Aura Spa
- 15 Aura Hill Spa
- 16 Activity Centre
- 17 The Boat House Restaurant
- 18 Solar Farm





PLEASE CONTACT OUR RESERVATIONS TEAM  
FOR MORE INFORMATION

[reservations@bawahreserve.com](mailto:reservations@bawahreserve.com) **Whatsapp:** +62 813-1297-2018  
Bawah Reserve, Anambas, Pulau Bawah, Indonesia